

- Before use, please read this manual and be sure to use the dryer properly. The manufacturer assumes no responsibility for the dryer when it is used in ways other than the proper method described in this manual. In particular, be sure to read the Safety Warnings.
- Store the manual in a location where it can be easily accessed at any time.

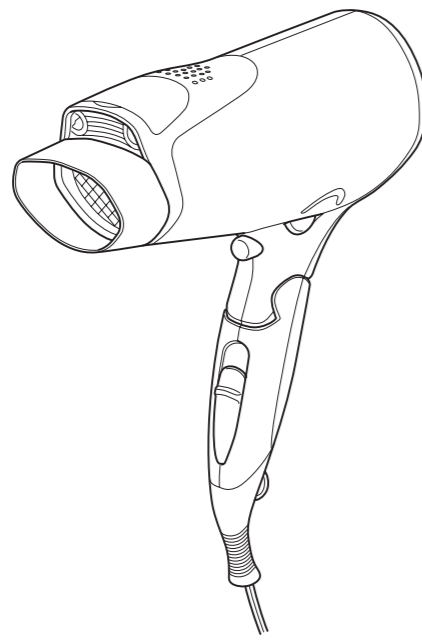

## Safety Warnings

- Make sure to turn the switch OFF and unplug the dryer after use.
- Pull on the power plug instead of the power cord when unplugging the dryer.
- Make sure to supply the dryer with voltage of AC220-240V.
- Plug the dryer into an AC outlet with a rated current of 8A or higher without any power strip or any other devices.
- Do not use the dryer if the inside of the main unit turns red, if it generates smoke, or if you hear the sound of foreign matter moving inside it.
- Regarding the power cord, do not damage, forcibly bend, twist, pull, load any heavy weight onto, bring near to any hot object, pinch, modify, or bundle it when using the dryer. Do not wrap the cord around the main unit.
- Long-term use or misuse may cause the power cord to break. Do not use it if:
  - The dryer sometimes does not blow air;
  - The power cord remains twisted;
  - The base of the power cord or plug is deformed or damaged;
  - The power plug is loose in the AC outlet.
 If the supply cord is damaged, it must be replaced by the manufacturer, its service agent, or similarly qualified persons in order to avoid a hazard.
- Do not leave the dryer with the power switch turned ON. Do not put the dryer on anything flammable or sensitive to heat, such as a mattress, paper, or plastic bags.
- Do not use it on babies. Do not have a child close by when using it. This dryer should be stored out of reach of children.
- This appliance is not intended for use by persons (including children) with reduced physical, sensory or mental capabilities, or lack of experience and knowledge, unless they have been given supervision or instruction concerning use of the appliance by a person responsible for their safety. Children should be supervised to ensure that they do not play with the appliance.
- Do not use the dryer near any flammable material, such as gasoline, benzene, thinner, gas, or hair cosmetics agents. Do not use the dryer with hairspray.
- Keep the air intake and outlet clear during use.
- Do not insert any foreign matter, such as a hair pin, into the air intake or outlet.
- Do not look into the air outlet during use.
- Keep the air intake at least 10 cm away from hair to prevent hair from being sucked into the dryer during use. Do not use if the air intake is damaged.



This symbol indicates that this appliance must not be used near water, such as baths or basins with shower water.

Do not use this appliance near bathtubs, showers, basins or other vessels containing water.

When the dryer is used in a bathroom, unplug it after use since the proximity of water presents a hazard even when the dryer is switched off.

For additional protection, the installation of a residual current device (RCD) having a rated residual operating current not exceeding 30 mA is advisable in the electrical circuit supplying the bathroom.

- Do not use the dryer with wet hands.
- Do not place the dryer in water or pour water on it.
- Store it in a place with low moisture.
- Do not modify the dryer. No one other than repair engineers should disassemble or repair the dryer.
- Clean the air intake at least once per month.
- Keep the air outlet at least 3cm away from hair. Do not blow hot air onto one location for too long.
- Do not touch any attachment or the air outlet during or immediately after use, and also avoid any accidental contact with your skin, as the attachments and the outlet will be hot.
- The dryer is intended for the hair-drying and styling of human hair. Do not use it for other purposes, such as for pet hair, wigs, or hairpieces.
- Do not let the dryer fall or sustain impact. Do not use it if has been damaged.
- Do not touch the dryer with hair dye-stained hands. Never apply alcohol, benzene, or enamel remover.
- The dryer is not intended for business use. Keep it away from unspecified usage by a large number of people.

When opening or collapsing the grip, do not put your finger on the shaded parts, and do not perform the opening or collapsing action too quickly.

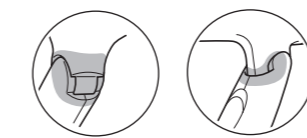

## Troubleshooting

Issue	Possible cause	Solution
Hot or cool air comes out unintentionally. A spark appears from the air outlet. (A spark is caused by the safety device.)	Dust and hair have become attached to the air intake. The air intake is blocked.	Maintain the air intake. Remove any objects that block the air intake. If this does not eliminate the problem, stop using the dryer.
The main unit or hot air is abnormally hot. The inside of the main unit becomes red or generates smoke.	The safety device is not operating normally.	Immediately stop using the dryer.
No air blows out.	The power cord has been broken.	
Air comes out but stops from time to time.	The power cord is about to break.	
The base of the power cord or plug is deformed or damaged.		
The power cord remains twisted.		
Something sounds as though it's moving around within the main unit.		
Power plug is abnormally hot.	The plug is connected to the AC outlet in a loose manner.	The AC outlet may have a problem. Consult an electronics appliance store.

The following people may have trouble seeing results from nanions and collagen.  
 \* People with wavy hair, people with curly hair, people with fine soft hair, people with short hair, people who have just straightened their hair, people with naturally moist hair.

## Part names and functions

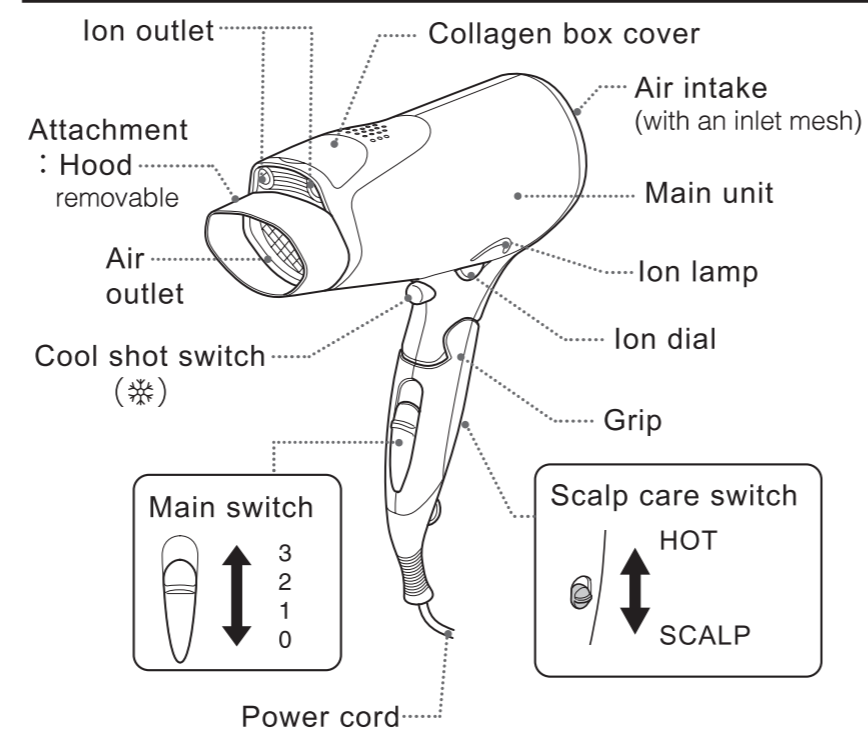

- **Collagen box**  
 Contains collagen ingredients Attached to the main unit. The collagen box is effective for about 2 years. (When used 30 minutes per day) We recommend changing the box about every 2 years. Ask for replacement parts at the point of purchase.

### How to change the collagen box

Open the collagen box cover and replace the collagen box.

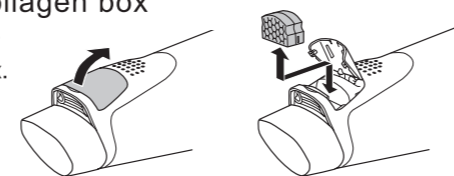

## How to use

- 1 **Insert the power plug into an AC outlet.**
- 2 **Select air temperature with the scalp care switch.**  
 •HOT...hot air to dry hair swiftly  
 •SCALP...moderate air temperature to dry hair while caring for hair
- 3 **Set the main switch to 3, 2 or 1 and blow hair with the dryer.**  
 3 and 2 is suitable for blow drying hair after washing, while 1 provides a gentle airflow suitable for setting hair.

**How to use the Cool shot switch (snowflake symbol)**  
 After arranging hair with hot air, switch to cold air and apply it to the hair for 10 to 15 seconds to maintain a hair setting for a long period of time.

**Ion dial**  
 Adjust the amount of negative ions emitted from the ion outlet. The color of the ion lamp varies according to the position of the ion dial.



- 4 **Turn the main switch to [0] and remove the power plug from the outlet.**

## Maintenance

Set the main switch to [0] and unplug the unit from the AC outlet before performing maintenance.

### Main unit

Wipe away any dirt with a dry soft cloth. To clean off difficult dirt, immerse a cloth in soapy water or neutral detergent diluted with water, wring it dry, and wipe away the dirt.

### Air intake

Remove the inlet mesh. Dust it. IF dust is not removed, use a vacuum cleaner or wash it with water. After washing it with water, dry it to a sufficient degree.

After deattaching the inlet mesh, remove hair, dust, etc. on the inlet with a soft brush or the like.

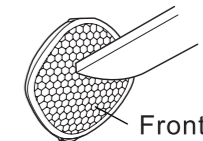

\*Do not use a vacuum cleaner on the back side of the inlet mesh.

- How to detach the inlet mesh
- How to attach the inlet mesh

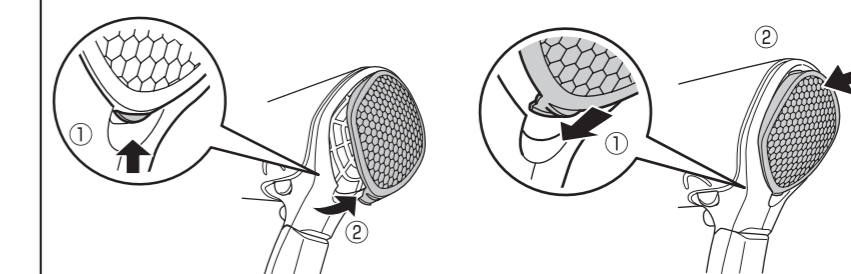

Specifications	
Product number	NTCD41
Power Source	220-240V~ 50-60Hz
Power consumption	1350-1600W
Power cord length	1.7m